



**ACCUSHOOT**  
LFX

The Future of Shooting is Here

---

Bringing Dynamic  
Targeting Capabilities to  
Your Range

**PRODUCT OVERVIEW**

PATENT PENDING

Marksmanship training has not changed much in the last 100 years despite rapid technological advances. Paper, cardboard, or steel targets with little to no movement still dominate the traditional training sessions. Unfortunately, real-world shooting encounters are highly dynamic in nature with a variety of moving targets. Without the proper training mimicking realistic scenarios, your marksmanship skill will let you down when you need it most.

AccuShoot LFX brings a high level of dynamism to your training regimen, without the need for expensive simulators. It offers a variety of classic and popular drills, qualifications, skill tests, challenging games, real-world scenarios, and pistol and rifle competitions. The AccuShoot LFX System provides a versatile and immersive training experience. Its stable, collapsible design makes it perfect for both indoor and outdoor use. AccuShoot LFX is designed to revolutionize your shooting practice



## The Next Level of Firearms Training



AccuShoot LFX combines the instant gratification of steel targets, the accountability of paper, no risk of spall or ricochets, no need to walk downrange to score and paste, targets that actually move, and automatic data collection for real-time performance tracking.

### Ghosts

Thrilling arcade game where multiple ghosts will appear and the shooter must hit them twice to make them disappear

#### MOST USED

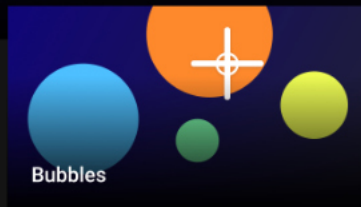

#### QUALS

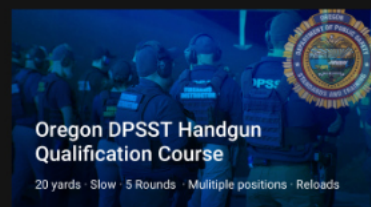
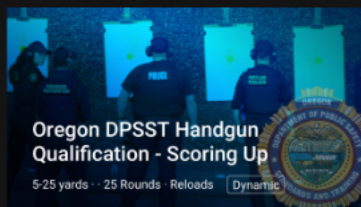
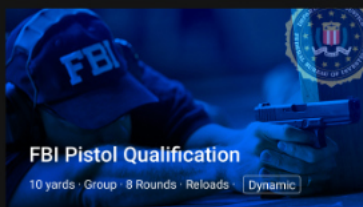

#### SKILL TESTS

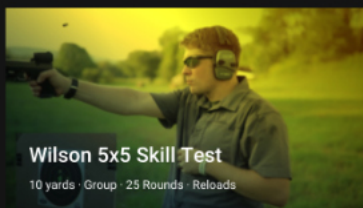

#### POPULAR DRILLS

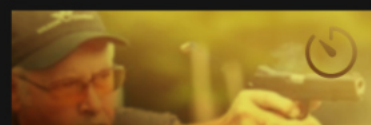
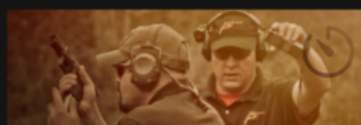

# LFX ADVANTAGES

## **TRAIN AS YOU FIGHT**

Use your own gear, including real firearms, optics, and live ammunition, rather than simulation equipment.

## **TRAIN EFFICIENTLY**

Spend all your time training and none on setup, scoring, pasting targets, or recording results.

## **TRAIN EFFECTIVELY**

Tailor drills and training sessions to match the skill level of each shooter.



# WHAT MAKES ACCUSHOOT LFX UNIQUE?



## REAL GUNS

From Colt Peacemaker .22 to Sig Spear .308 Battle Rifle, all calibers are detected according to the specs of your particular range. No more toy guns that fail to deliver real shooting experiences.

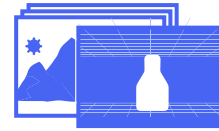

## LIMITLESS SCENARIOS

Dynamic shooting games featuring shoot and no-shoot targets that move at varying speeds, simulated scenarios with progressively increasing difficulty to match the requirements of any qualification, and the groundbreaking Dynamic Drills that challenge even the most advanced shooters.

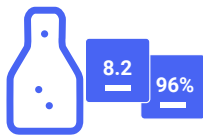

## AUTOMATED QUALIFICATIONS

Automate and record firearms training and qualifications of your law enforcement agency, achieving a new level of transparency.

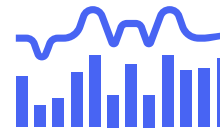

## ADVANCED ANALYTICS

Provide your shooters with personalized feedback through analytics that help them understand their current performance and potential for future improvement.



## BUILT-IN PROGRAMMABILITY

Customize the drills to your liking so your instructors and shooters can navigate the best-fitting courses and the latest techniques.



## FUN & ENGAGING

Create a leaderboard for each drill to determine who is best in your range, city, state, or nation. Organize your own competitions to drive more business.

# LFX SYSTEM

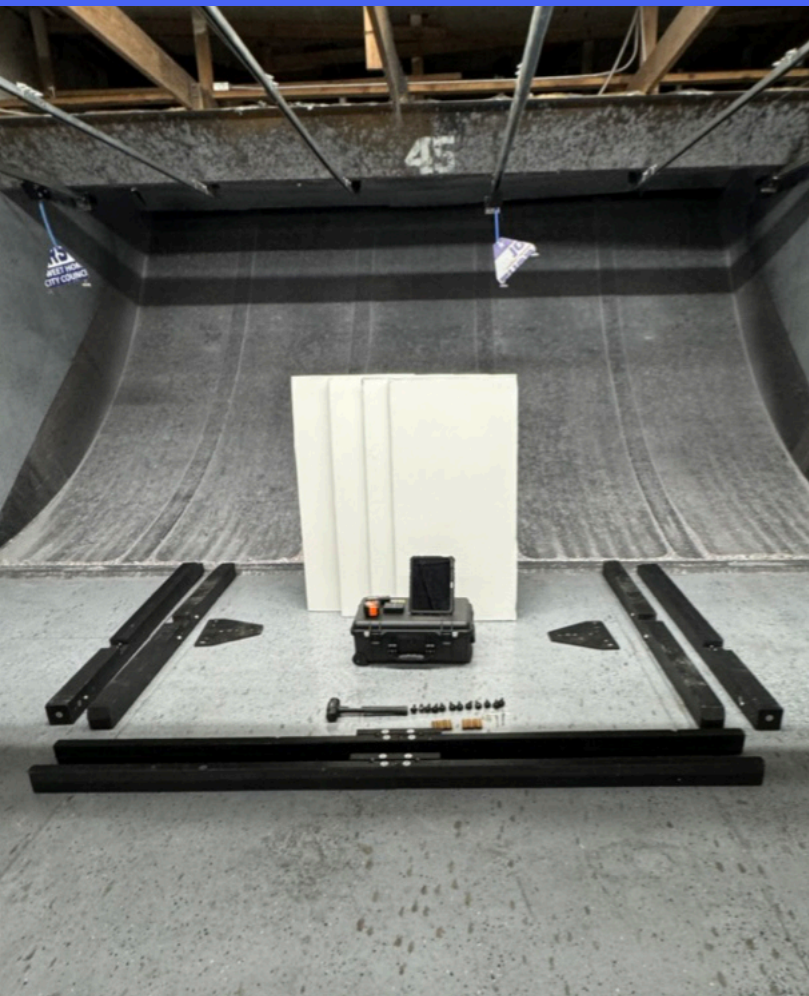

This complete package includes the LFX box (projector, shot detector, internal computer, and speakers), calibrator, stand, two screens, and a one-year subscription to LFX's popular drills, skill tests, and games.

## **RUGGED**

For outdoor or indoor installation.

## **FLEXIBLE SETUP**

On the ground, on the ceiling, or downrange behind cover for long distances, with the shooter positioned at any distance, from as far as possible to as close to the screen as needed, in order to avoid.

## **EASY-TO-USE INTERFACE**

Intuitively operate, configure, calibrate, and test; efficiently manage and inspect content, leaderboards, and sessions.



# LFX SOFTWARE SPECIFICATIONS

## 1 MANAGER



Settings, Analytics, User Management, Screen Management, Status, and Updates

## 2 INSTRUCTOR

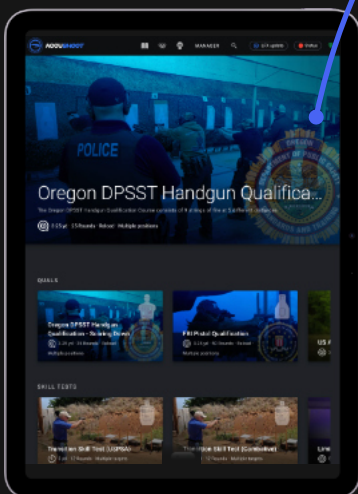

Selects drill, manages users, and configures screens.

## 3 SESSIONS

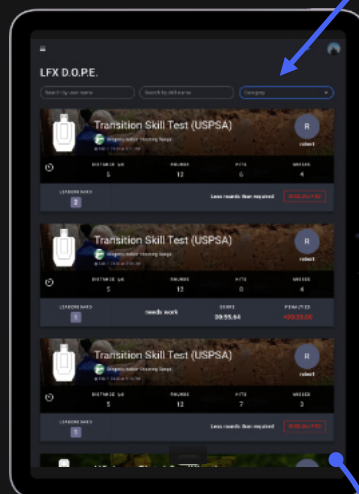

Records sessions to be analyzed later.

## 4 LOCAL LEADERBOARD



Top local shooters per drill and time period.

5 D.O.P.E

ACCUSHOOT.COM

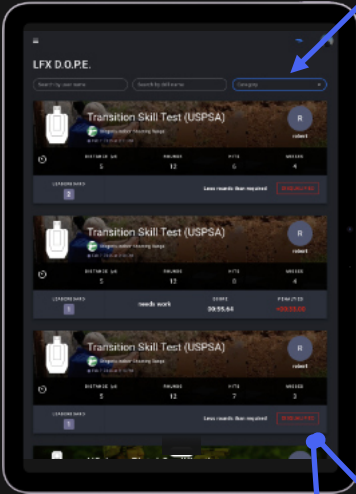

Historical sessions.

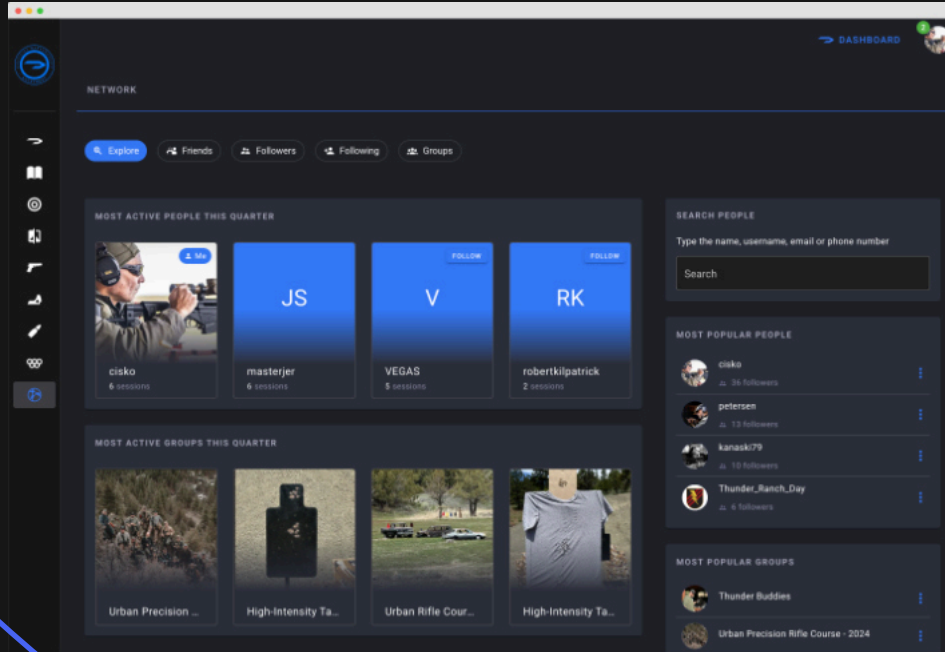

6 PERSONAL LOCKER

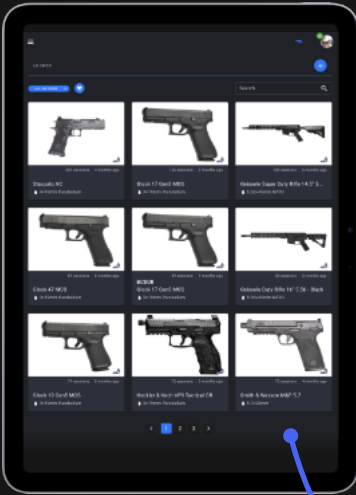

Personal Locker for Weapons, Ammo, and Accessories.

7 GLOBAL LEADERBOARD



Top global shooters per drill and time period.

8 PERSONAL PERFORMANCE



Performance across weapons, ammo, and time.

# LFX STAND AND SCREEN

## STABLE

The stand remains stable even if bullets pass through the screen.

## WIND RESISTANT

If used outdoors, it resists movement from wind.

## COLLAPSIBLE

Designed for easy transport and setup.

## MODULAR PANELS

The screen and stand break into smaller parts for easy transport.

## EASY ASSEMBLY

The panels are easily detachable making setup quick and straightforward.

## DURABLE MATERIALS

Features a ballistic rubber facing material laminated to a rigid backing board. The facing material provides excellent thermal characteristics, clearly showing impacts in thermal video while dissipating heat quickly to avoid thermal saturation. Additionally, it has self-healing properties, closing around bullet holes. The rigid backing board ensures stability and allows bullets to pass through cleanly without material blowout at exit sites.

## CUSTOMIZABLE

You can easily adjust the size of your screen by using taller or shorter poles, or longer or shorter beams.



# Screen and Stand Components

Easily adjust the screen size with different pole and beam lengths.

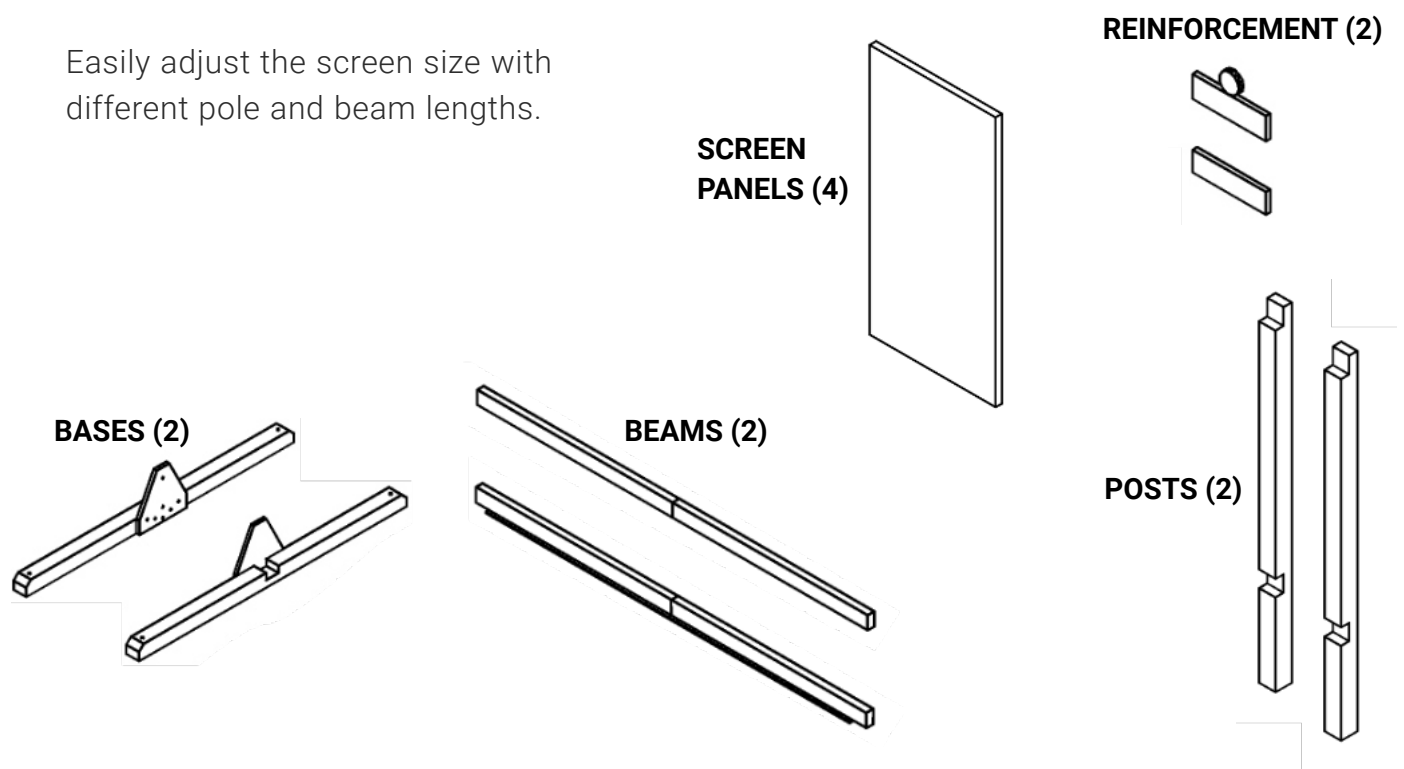

# Technical Drawings

## Stand

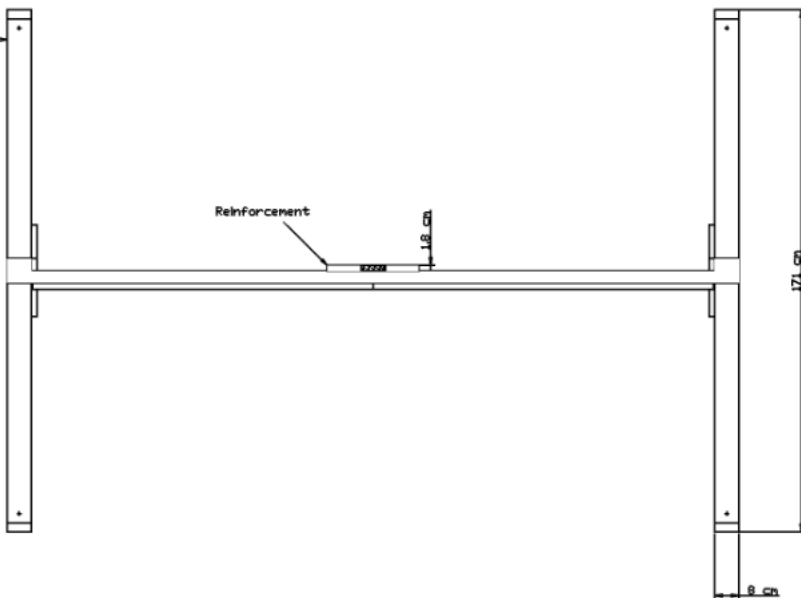
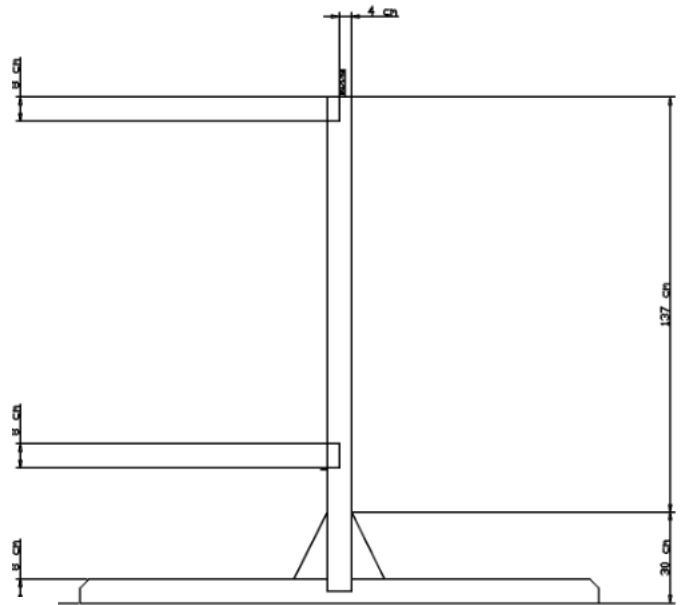
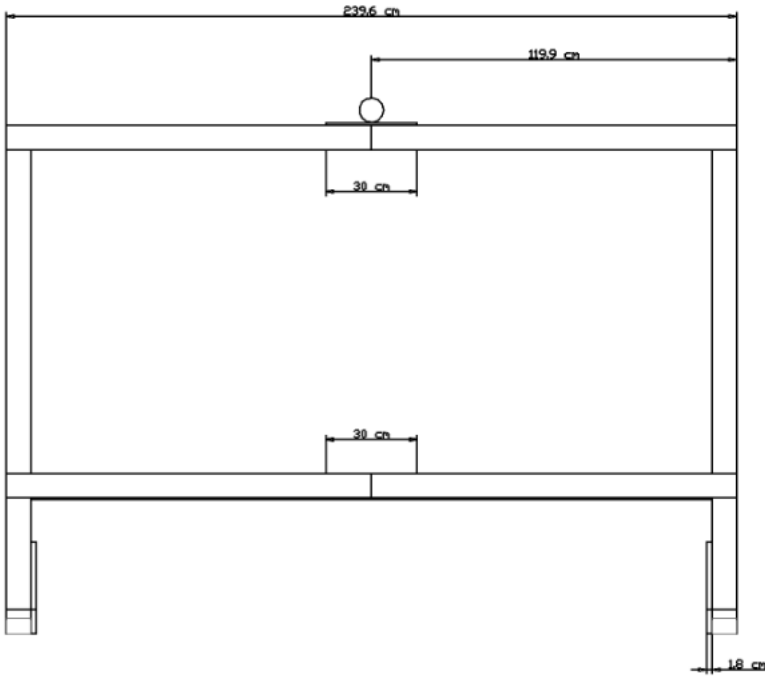
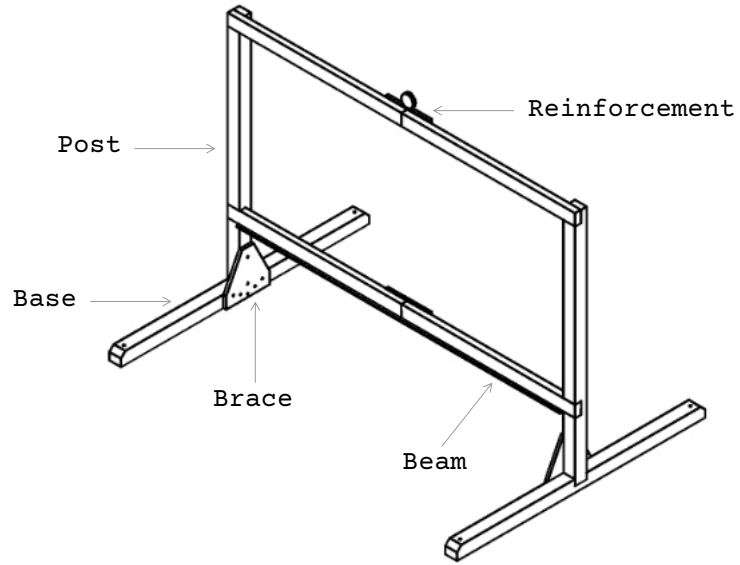

## Brace detail

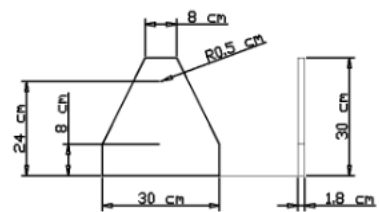

## Screen

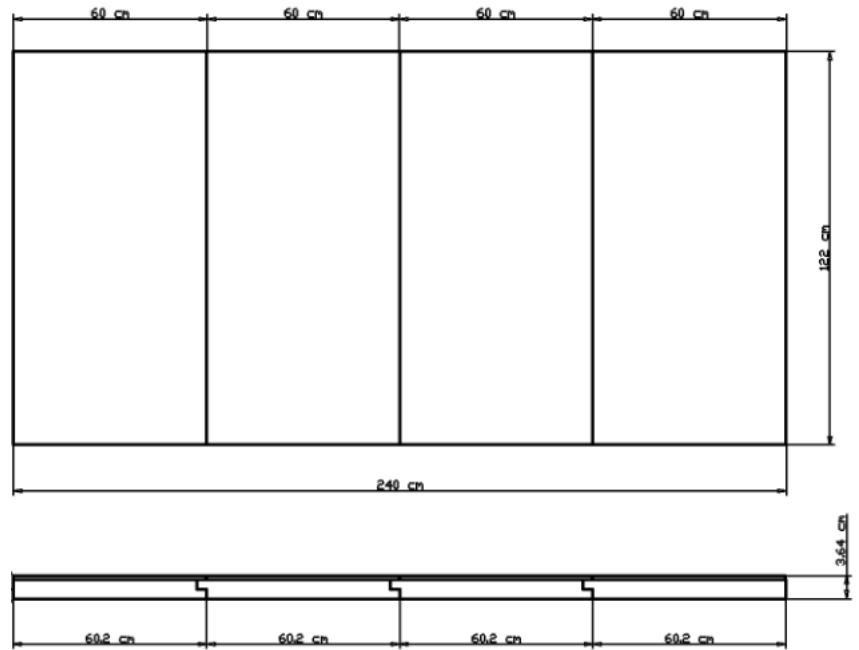
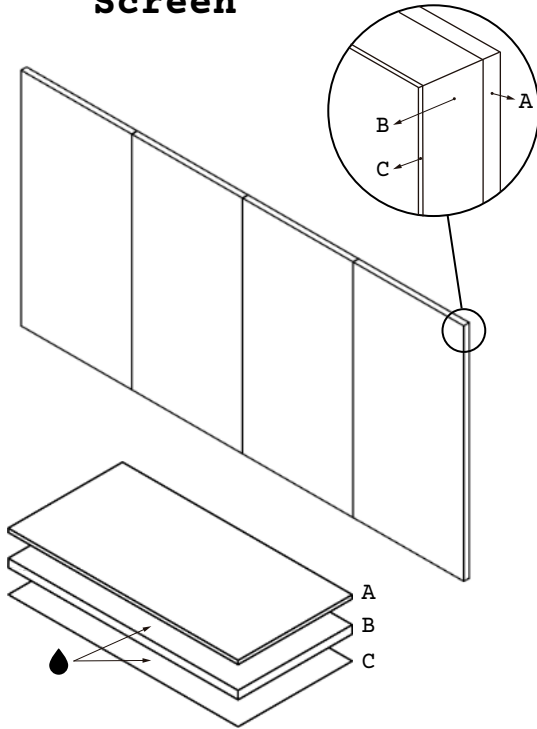

### Screen Materials

A. Polycarbonate 6mm

B. Polystyrene 30mm

C. PVC 0.4mm

● 3M Super 77 spray adhesive. It is important that B is glued "smooth side" to C

## Optimal Dimensions of Stand

Key measures ensuring stability:

- Screen Frame:  
122.4 cm H × 239.6 cm W  
(outside dimension).
- Frame Height:  
44.6 cm above ground level.

Construction can be modified provided that optimal dimensions are maintained.

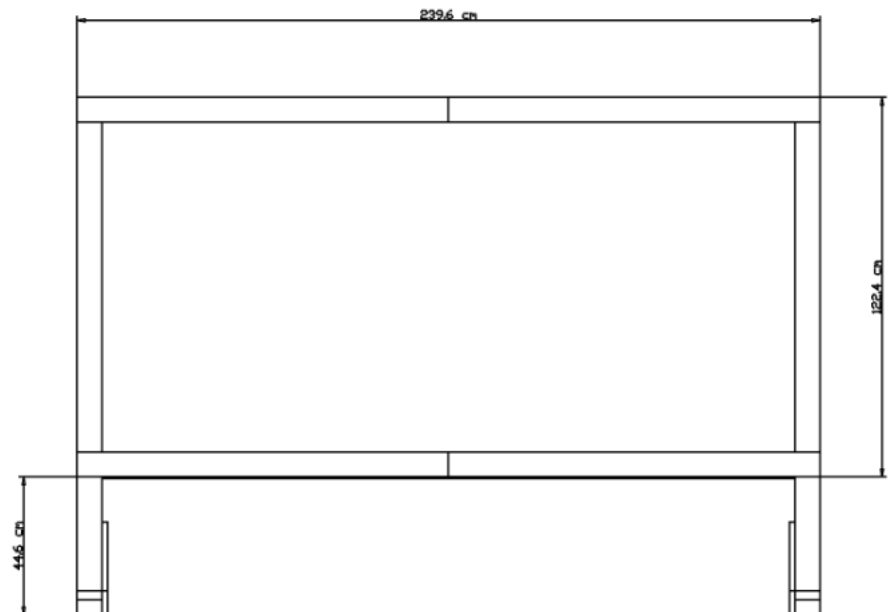

Smaller and larger stands and screens can be configured.  
Feel free to contact us to share details about **your specific setup** or to learn more about our various screen configurations.

# Assembly steps



**Connect the upper beams** using the connectors. Insert the connectors into the ends of the upper beams.



**Connect the lower beams** using the connectors. Repeat the process with the lower beams, joining both ends with connectors.



**Add reinforcements to the upper beams.** Attach the reinforcement board to the already connected upper beams with the connections pieces.



**Add reinforcements to the lower beams.** Repeat the previous step for the lower beams.



**Attach the braces to the bases.** Secure the diagonal reinforcements to the left and right bases using the provided bolts



**Attach the beams to the vertical posts.** Secure the upper and lower beams to the vertical posts using bolts.



**Assemble the main structure.** Place the upper structure (beams + posts) onto the bases.



**Secure the main structure** to the braces. Attach the main structure to the braces, tightening all bolts to ensure stability

# AFX BOX

## COMPACT SIZE

Designed to be compact for easy storage and handling without compromising functionality.

## PORTABLE

Fits into a Pelican 1510 travel case (not included), allowing you to move the box effortlessly to different locations.

## ADJUSTABLE

Telescopic legs allow precise alignment of the projected image, accommodating various setups and surfaces.



# Box Components

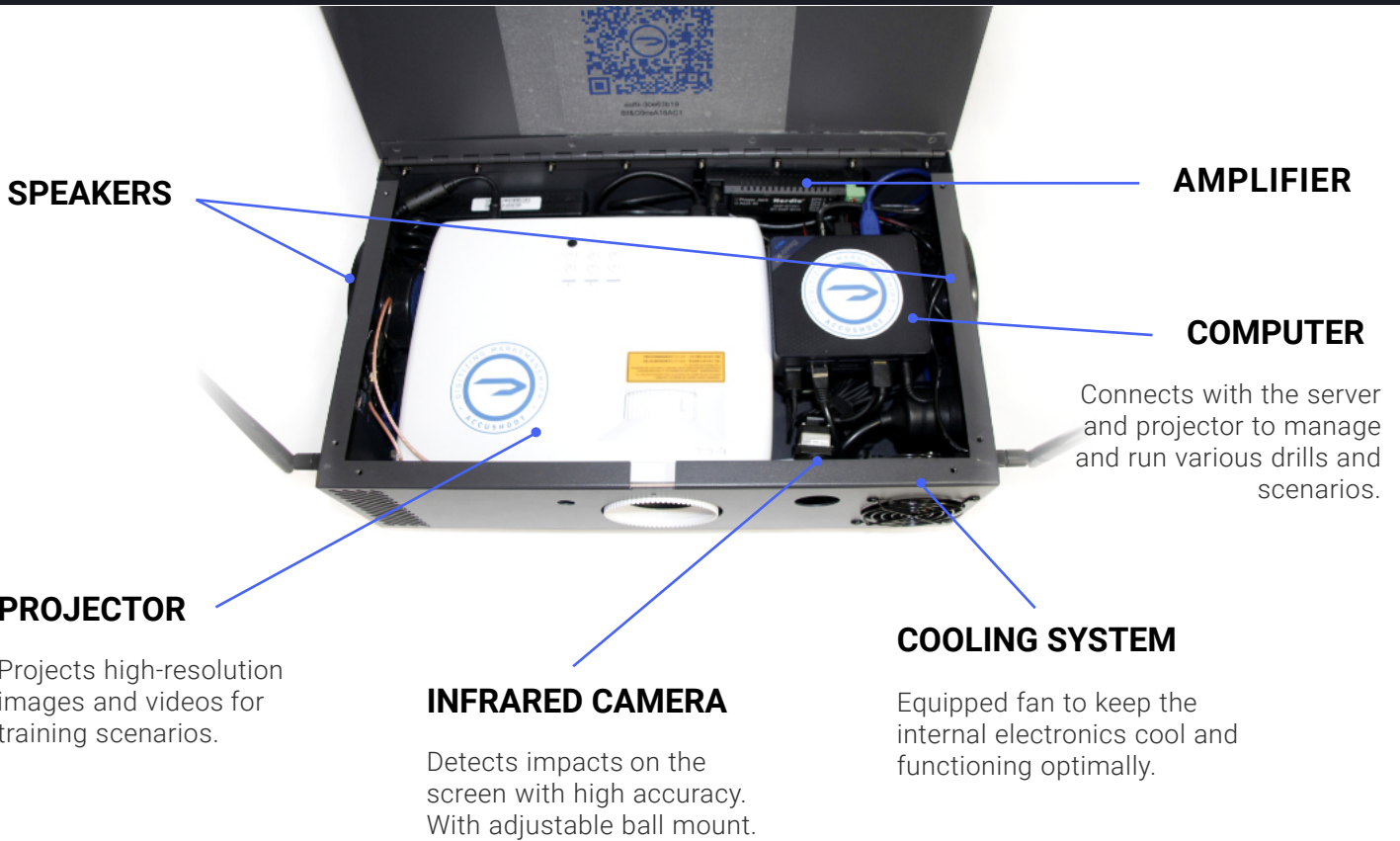

# Technical Drawings

## BASE

.064, ALUMINUM 5052-H32 ( $\pm 0.0040$ )  
 GRAPHITE SANDTEX, PA-0191-LT, LOW GLOSS, FINE TEXTURE, POLYESTER POWDER  
 MONSTERJET PRINTABLE FACES:1

## INTERNAL HINGE COVER

.060, 16GAGE, COLD ROLLED STEEL ( $\pm 0.005$ )  
 GRAPHITE SANDTEX, PA-0191-LT, LOW GLOSS, FINE TEXTURE, POLYESTER POWDER  
 MONSTERJET PRINTABLE FACES:1

## SPACER PLATE

.250, ALUMINUM 5052-H32 ASTM ( $\pm 0.014$ )  
 GRAPHITE SANDTEX, PA-0191-LT, LOW GLOSS, FINE TEXTURE, POLYESTER POWDER

## COMPUTER BRACKET

.064, ALUMINUM 5052-H32 ( $\pm 0.0040$ )  
 GRAPHITE SANDTEX, PA-0191-LT, LOW GLOSS, FINE TEXTURE, POLYESTER POWDER

## STEEL PIANO HINGE (15665A294 6FT)

STEEL PIANO HINGE 1.5IN OPEN WIDTH, .060 THK,6FT, .125IN PIN DIA (15665A294)  
 GRAPHITE SANDTEX, PA-0191-LT, LOW GLOSS, FINE TEXTURE, POLYESTER POWDER

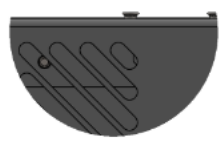
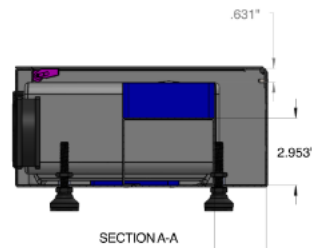
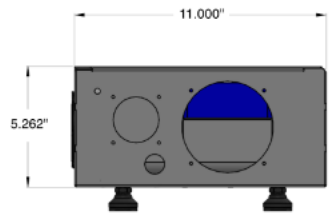
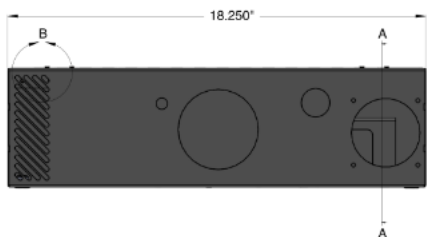
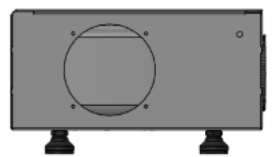
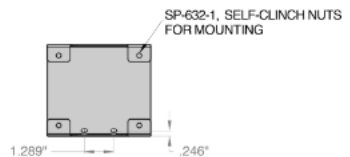
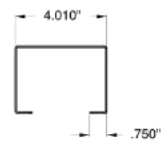
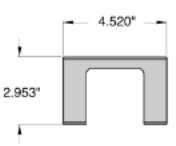
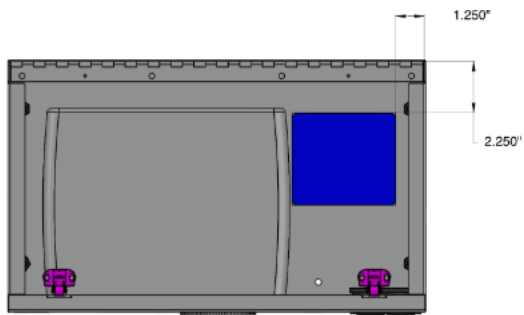
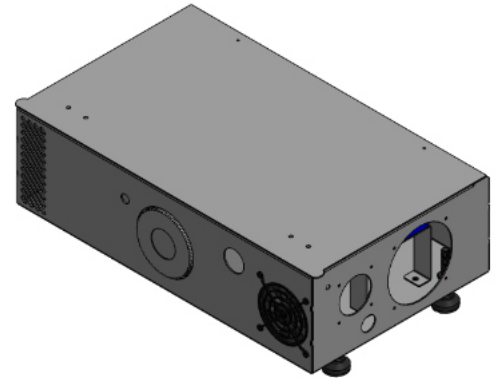

DETAIL B  
SCALE 2 : 1

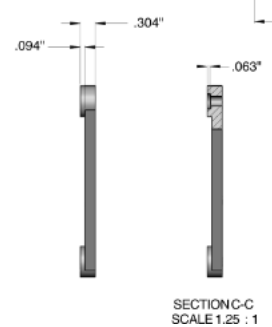
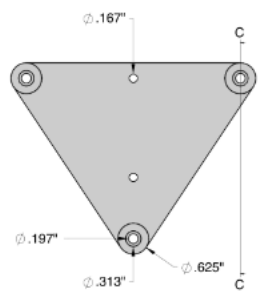
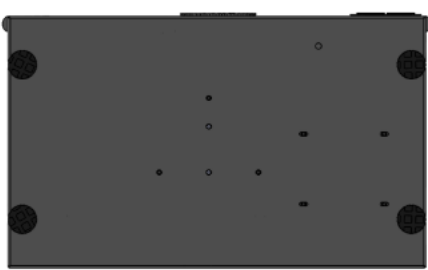

SECTION C-C  
SCALE 1.25 : 1

# STANDARD PLACEMENT AND SETUP

The LFX System can be set up in various configurations—on the ground, underground, on the ceiling, or at different distances—to provide flexible projection sizes. AccuShoot is happy to work with you to create a setup tailored to your specific needs, safety requirements, and training goals.

A standard setup is as follows:

**LFX STAND PLACEMENT:** Ensure stability and proper alignment with the LFX Box.

**LFX SCREEN PLACEMENT:** Properly align the four panels to form a seamless projection surface. If it used outdoors a canopy or awning might be needed to avoid.

**LFX BOX PLACEMENT:** Position the LFX box at an optimal distance to avoid interference and ensure proper projection and detection. It can be on the ground, underground, or hanging from the ceiling. Depending on the setup, an armored or fiberglass cover may be required to protect the box.

## DISTANCES TO SCREEN

**LFX Box to Screen:** recommended 5 yards or 4.5 meters

**Firing line:** As close as the user does not interfere with the projection and any distance.

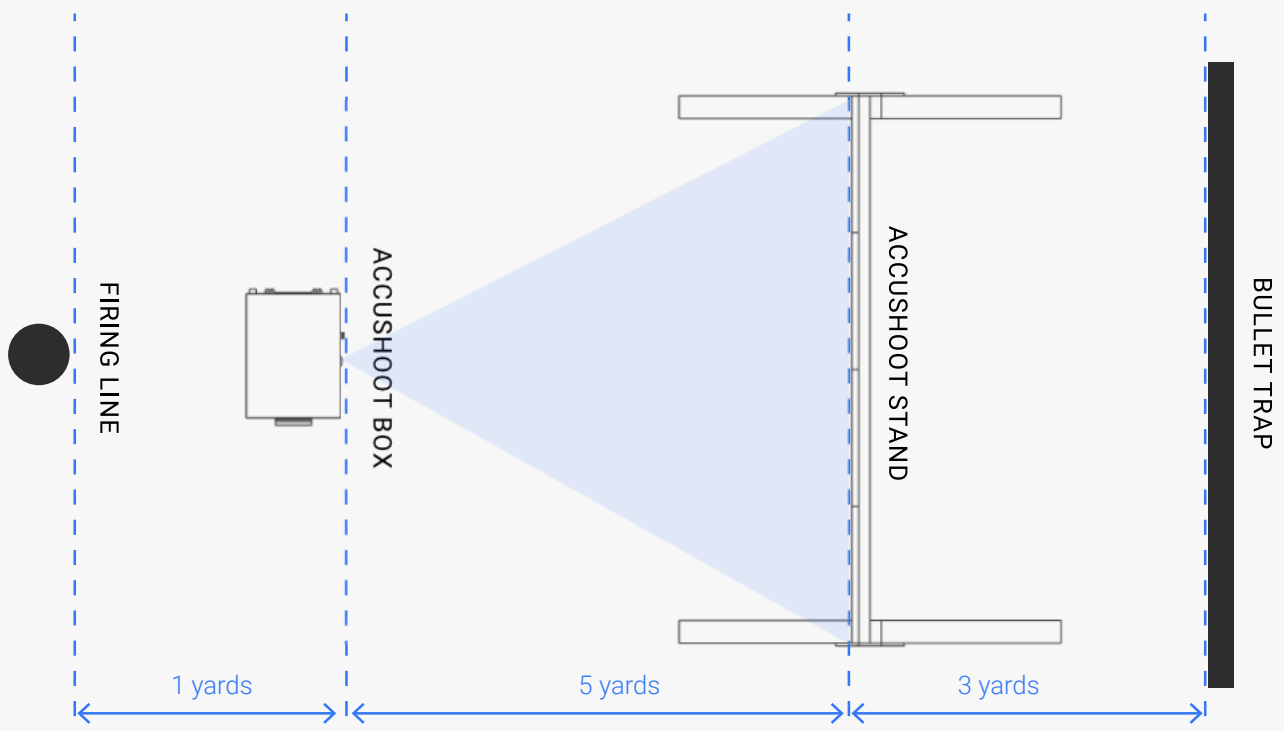

# ACCUSHOOT LFX PLATFORM

## OVERVIEW

The LFX Platform is a modular system that provides a number of user-friendly interfaces that allow to easily configure and manage the LFX Box, display shooting sessions and leaderboards, and synchronize the data with AccuShoot.com.

## LFX PROJECTION

Projects targets and displays a number of configurable panels to show distance, split times, elapsed or remaining time, offset for each shot, score, user, and markers of different size to visually identify the impacts on the screen.

## ADMINISTRADOR DE LFX

Modo de administración del sistema para la gestión de la configuración y la supervisión del rendimiento.

Settings	Manage screen and stand lifespan, adjust display settings, and configure connectivity.
Leaderboards	Manage active leaderboards and those displayed in the carousel.
Content Manager	Organize drills available in AccuShoot LFX by category and audience.
Analytics	View system statistics: number of sessions, rounds, active users, top users, and top drills.
Session Feedback	Report session issues to the support team.
Status	Monitor the LFX system's status (memory, storage, CPU temperature, updates, screen lifespan).
About	Manage your AccuShoot account, check subscription status, and view available updates.

## LFX INSTRUCTOR

Session management mode for organizing and administering training sessions.

User Management	Create, add, or remove users for training sessions.
Drill Session Management	Select sessions and users, and oversee the session's progress.

## LFX SESSIONS

Mode for viewing the history of completed sessions.

Session Listing and Filtering	Displays a list of past sessions with filters for user, drill, or category.
Session Detail	Provides detailed information about the results of the selected session.

## LFX LEADERBOARD

Mode for viewing historical leaderboards.

Leaderboard Carousel	Shows a carousel with the top 10 positions from each active leaderboard.
Leaderboard Display	Full detailed view of a specific leaderboard.

## ACCUSHOOT.COM LFX

Online platform where users can access their data generated in AccuShoot and manage their shooter profile.

Ranges	List and details of shooting ranges using AccuShoot LFX.
Global Leaderboards	View the history of leaderboards created in AccuShoot.
D.O.P.E. - LFX Sessions	Access the complete history of recorded sessions in AccuShoot.
Shooter Performance	Private performance tracking (shot history, training level, performance prediction, and evolution).
Locker	Private virtual locker for managing firearms, ammunition, and accessories.
Network	Explore the AccuShoot community and manage friends, followers, and groups.

## LFX APP

Mobile application where users can access their data and manage their shooter profile.

Ranges	List and details of shooting ranges using AccuShoot LFX.
Global Leaderboards	View the history of AccuShoot leaderboards.
D.O.P.E. - LFX Sessions	Access the history of recorded sessions in AccuShoot.
Locker	Private virtual locker for managing firearms, ammunition, and accessories.
Network	Explore the AccuShoot community and manage friends, followers, and groups.

# ACCUSHOOT LFX SYSTEM DATA

COMPONENT	SPECIFICATION
<b>STANDARD LFX SYSTEM SETUP</b>	
Standard Screen Dimensions (approx)	48 in (162 cm) high x 96 in (244 cm) wide
Standard Stand Dimensions (approx)	72 in (183 cm) high x 96 in (244 cm) wide x 68 in (173 cm) deep
<b>LFX BOX</b>	
Video	Compact, Full HD 1080p laser projector
Resolution	1920 x 1080
Brightness	4500 Lumens
Camera	NDA-compliant and ITAR-free longwave infrared (LWIR) thermal camera module
Resolution	640 x 512
Pixel Pitch	12 $\mu\text{m}$
Spectral Band	8 $\mu\text{m}$ – 14 $\mu\text{m}$
Sensitivity (NE $\Delta$ T)	<60 mK
Frame rate	30 Hz
<b>Other Components</b>	
Audio	Integrated, amplified, 4" waterproof speakers
WIFI card	Creates a local wireless network
RJ45 port	For wired local connection
Power Requirements	100V ~ 240V, 50-60Hz
Dimensions	18" wide x 11" deep x 5 1/4" tall. Fits into a Pelican 1510 travel case (not included)
<b>LFX TABLET</b>	
Tablet Type	Optional tablet included; or use any iOS or Android tablet with up-to-date browser
Interface Type	Web-based
Connectivity Requirements	An internet connection is required for data storage via <a href="http://accushoot.com">accushoot.com</a>



**ACCUSHOOT**

**GET IN TOUCH**

Any questions or feedback? Fire away!

[info@arms-tec.com](mailto:info@arms-tec.com)



Warminster U.K.  
+44 (0)7798 726 900

[www.arms-tec.com](http://www.arms-tec.com)